



**PROFILCO**<sup>TM</sup>  
Aluminium Systems



Shutters systems  
Sisteme de obloane



**PROFILCO™**  
Aluminium Systems



**PROFILCO** was founded in 2001. The plant's manufacturing capacity amounts to 9,000 tons of profiles a year. PROFILCO's facilities currently cover an area of 17,000 m<sup>2</sup>. One of the Europe's most modern mechanical equipment includes an 1800 tones extruder along with a fully automated production providing profiles with straight surfaces and excellent geometries. A couple of ultramodern electrostatic powder coating units – one horizontal and one vertical with two dyeing cabins of the latest technology – implementing a full cycle of chemical preparation and a third dyeing unit specialized in wood colors utilizing the "sublimation" method, as well as a new fully automated thermal-brake profile production line supplement the industrial production.

PROFILCO has established an extensive sales network in 25 sales points in 6 countries: Greece, Bulgaria, Romania, Ukraine, Serbia and F.Y.R.O.M.

#### **RESEARCH AND DEVELOPMENT**

PROFILCO's aluminum systems are exclusively designed by the company's research and development division. The various applications of the systems and fitting operations of the profiles, as well as the design and use of the accessories are studied by the said division by means of special software. This is where the profiles are designed and the products undergo the final control before entering the market.

#### **LOGISTICS**

Profiles are handled and stored with the use of automatic carriages and an automatic warehouse with capacity of 1600 tones. PROFILCO, aiming at the best possible service offered to its clients in terms of quality and time of delivery, has ensured that the logistics division is manned with specialized staff. The members of the logistics division are fully aware of the market's needs and plan and distribute the products through a high-technology ERP system.

#### **CERTIFICATION**

The company's aluminum profile manufacturing process and conditions as a whole comply with ISO 9001, a standard guaranteeing the high quality of its products. Coating process is followed by SEASIDE CERTIFICATE for improved durability of the electrostatic paint at coastal areas. Moreover, the company's systems have been certified by laboratories approved by the European Union.

#### **THE ENVIRONMENT**

PROFILCO is an extremely environmentally aware company and has therefore installed and set in operation an ultramodern biological waste treatment unit. The physicochemical unit processes the dyeing unit's liquid waste by means of chemical reagents and special techniques. In this way, the company ensures the environment-friendly nature of the manufacturing processes prevents and restricts the volume of waste and saves on energy, natural resources and consumable stores.

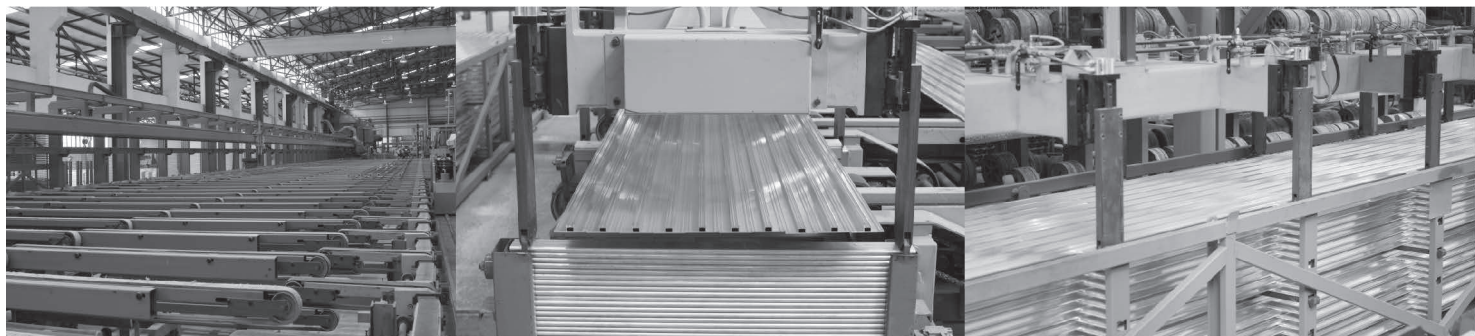





**PROFILCO** a fost înființată în anul 2001. Capacitatea de producție a fabricii se ridică la 9.000 de tone de profile pe an. Fabrica Profilco acoperă în prezent o suprafață de 17.000 m<sup>2</sup> și deține unele dintre cele mai moderne echipamente tehnologice din Europa, complet automatizate, ce includ linii de extruziune cu o capacitate 1800 de tone ce furnizează profile cu suprafețe drepte și finisaje excelente.

O pereche de unități ultramoderne de vopsire în câmp electrostatic - una orizontală și cealaltă verticală, cu două cabine de vopsire de cea mai recentă tehnologie - pun în aplicare un ciclu complet de pregătire chimică iar o a treia unitate de vopsire specializată în culori de lemn prin metoda "sublimare", împreună cu o nouă linie de producție de profile cu barieră termică, complet automatizată își aduc aportul la producția fabricii.

PROFILCO a dezvoltat o rețea de vânzări formată din 25 de puncte de vânzare în 6 țări: Grecia, Bulgaria, România, Ucraina, Serbia și FYROM

#### CERCETARE ȘI DEZVOLTARE

Sistemele din aluminiu Profilco sunt proiectate exclusiv de către divizia de cercetare și dezvoltare proprie. Diferitele aplicații ale sistemelor și operațiunile de montaj ale acestora, precum și proiectarea / utilizarea accesoriilor sunt studiate de divizia menționată cu ajutorul programelor informatice specializate. Acest lucru se face întotdeauna în cadrul proiectării precum și la control final, înainte de lansarea produselor pe piață .

#### LOGISTICA

Profilele sunt manipulate și depozitate cu ajutorul echipamentelor automate existente într-un depozit cu o capacitate de 1600 tone. PROFILCO, ținând cele mai bune servicii oferite clienților săi în ceea ce privește calitatea și timpul de livrare, se asigură întotdeauna că divizia de logistică este condusă de personal specializat. Membrii diviziei de logistică sunt pe deplin conștienți de nevoile pieței și planifică/distribuie produsele prin intermediul unui sistem ERP de înaltă tehnologie.

#### CERTIFICARE

Procesul și condițiile de fabricare a profilelor de aluminiu se realizează în conformitate cu ISO 9001, un standard ce garantează calitatea înaltă a produselor PROFILCO. Procesul de vopsire este urmat de certificare SEASIDE pentru o mai mare durabilitate a vopselei aplicate în câmp electrostatic. Mai mult, sistemele companiei au fost certificate de laboratoare autorizate de Uniunea Europeană.

#### MEDIU

PROFILCO este o companie extrem de conștientă de mediu și, prin urmare, a instalat și pus în funcțiune o unitate ultramodernă de tratare a deșeurilor biologice. Unitatea fizică procesează deșeurile lichide provenite de la unitatea de vopsire, prin intermediul unor reactivi chimici și a unor tehnologii speciale. În acest fel, compania se asigură de caracterul ecologic al proceselor de fabricație prevenind și limitând volumul de deșeuri, economisind energie, resurse naturale și materii prime.

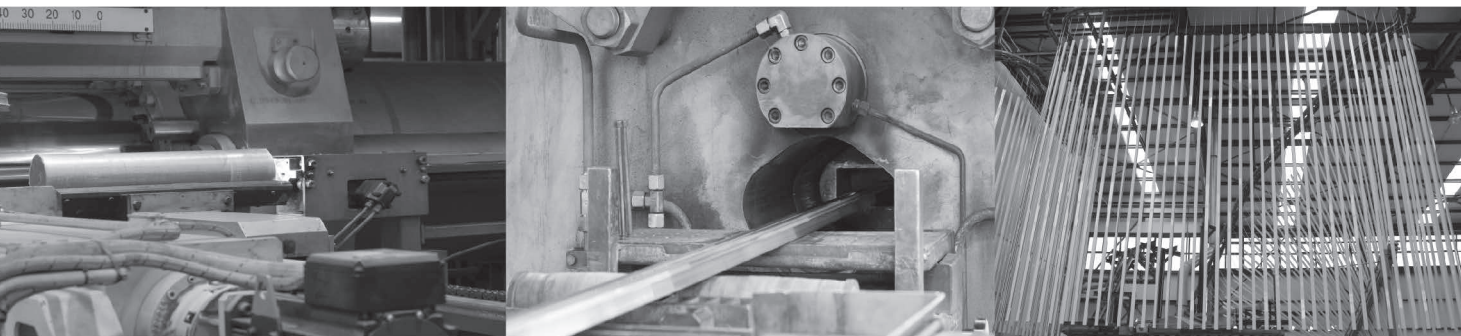



**PROFILCO**<sup>TM</sup>  
Aluminium Systems



## Shutters systems

**PROFILCO** provides aluminum systems for building shutters fixed or mobile, with one or more sashes and fixed or adjustable louvres.

Shutters made PROFILCO systems can have multiple colors and shapes to meet all architectural requirements.

**Structure** - Electrostatic painted aluminum

**Frame** - One chamber frame profile (width: from 44,8mm to 52mm and height: from 49,1mm to 53mm).

**Sash** - One chamber sash profile of width: 52mm and height: from 61,6mm to 91,4mm.

**Fills:** Blinds, slats, moving louvres, and panel fillings can be used as fills of the shutter sashes.

## Sisteme de obloane

**PROFILCO** furnizează sisteme din aluminiu pentru construcția de obloane fixe sau mobile, cu unul sau mai multe canate și lamele fixe sau reglabile.

Obloanele realizate cu sistemele PROFILCO pot avea culori și forme multiple ce satisfac toate cerințele arhitecturale.

**Construcție** - Aluminiu vopsit în câmp electrostatic

**Toc** - profil cu o cameră (grosime de la 44,8mm la 52mm și înălțime: de la 49,1mm la 53mm).

**Cercevea** - profil cu o cameră (grosime: de 52mm și înălțime de la 61,6mm la 91,4mm).

**Lamele** - se poate folosi în interiorul cercevelei lamele fixe, lamele reglabile sau panel.

## Content // Cuprins

Shutter profiles (summary) // Profile oblon (sumar)	3
Shutter profiles (1:1) // Profile oblon (1:1)	4
Shutter construction // Construcție oblon	14
Accesories // Accesorii	19



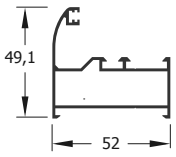

**AP052 - 201**  
777 gr/m

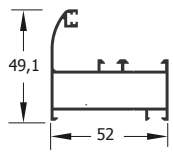

**AP052 - 214**  
786 gr/m

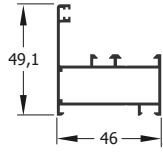

**AP052 - 216**  
728 gr/m

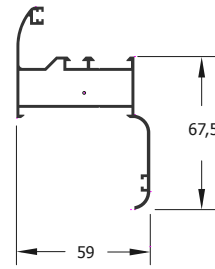

**AP052 - 208**  
991 gr/m

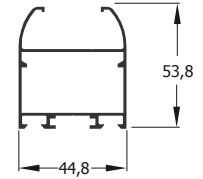

**AP048 - 303**  
897 gr/m

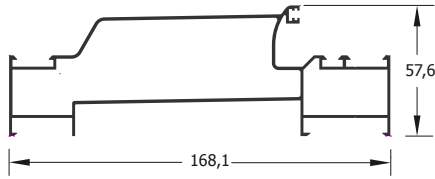

**AP052 - 212**  
2045 gr/m

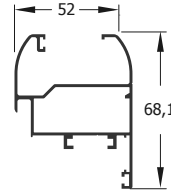

**AP052 - 313**  
982 gr/m

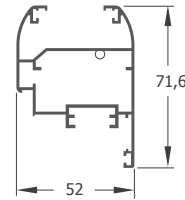

**AP052 - 307**  
1115 gr/m

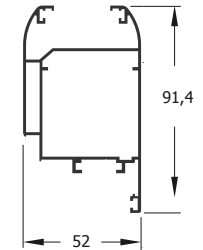

**AP052 - 308**  
1286 gr/m

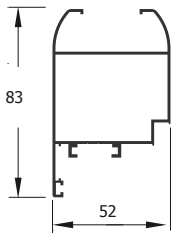

**AP052 - 309**  
1033 gr/m

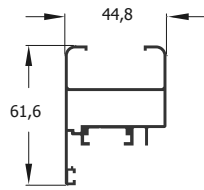

**AP052 - 310**  
892 gr/m

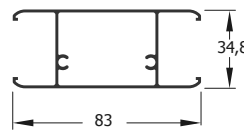

**AP052 - 407**  
937 gr/m

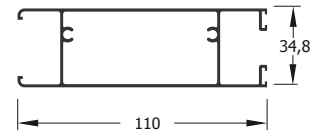

**AP052 - 409**  
1234 gr/m

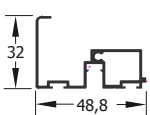

**AP052 - 539**  
.... gr/m

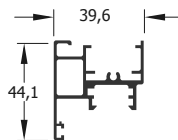

**AP052 - 536**  
793 gr/m

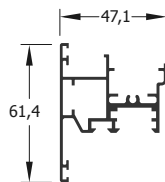

**AP052 - 544**  
987 gr/m

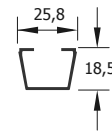

**AP035 - 509**  
233 gr/m

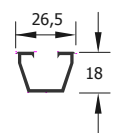

**AP052 - 523**  
254 gr/m

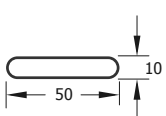

**AP010 - 302**  
349 gr/m

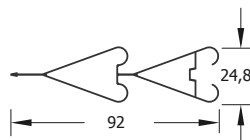

**AP010 - 300**  
597 gr/m

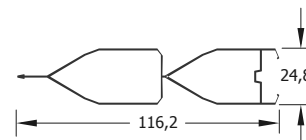

**AP010 - 304**  
708 gr/m

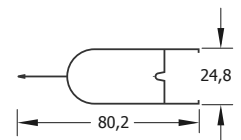

**AP010 - 301**  
449 gr/m

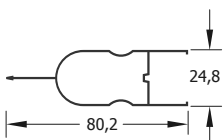

**AP010 - 303**  
488 gr/m

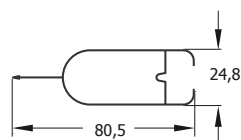

**AP010 - 306**  
466 gr/m

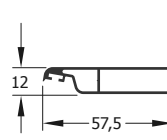

**AP010 - 310**  
461 gr/m

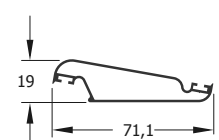

**AP010 - 311**  
535 gr/m

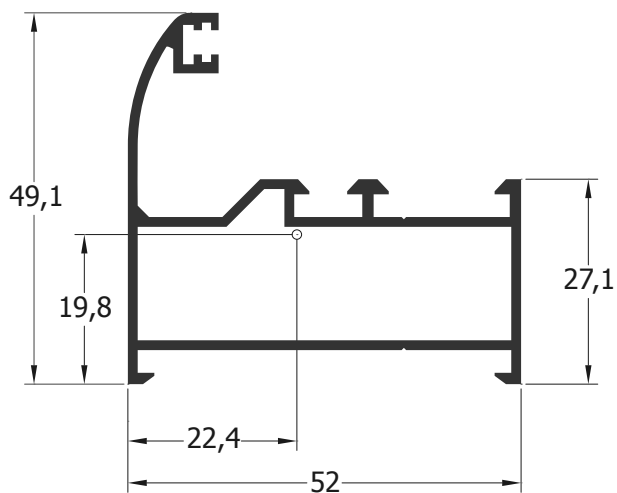

profile code cod profil	theor. weight greutate	length lungime
<b>52 - 201</b>	777 gr/m	6 m
<b>X,Y</b>	x= 52 mm    y= 49.1 mm	
<b>moments of inertia (Ix , Iy) moment de inerție</b>		
Ix= 5.1 (cm <sup>4</sup> )		Iy= 9.8 (cm <sup>4</sup> )
<b>moments of resistance (Wx , Wy) moment de rezistență</b>		
Wx= 1.74 (cm <sup>3</sup> )		Wy= 3.31 (cm <sup>3</sup> )
<b>accessories accesorii</b>		
AA052-119 or AA052-014 or AA052-071	Comer joint	Colțar
	Comer joint	Colțar
	Press comer joint	Colțar sertizare
AA052-047 or AA052-048	Alignment comer	Colțar aliniere
	Inox alignment comer	Colțar aliniere inox
AA052-004	Gasket central EPDM	Gamitură centrală EPDM
AA052-097	Vulcanized comer gasket	Colțar vulcanizat
AA052-554	Plug for drainage	Capac drenaj
AA052-006	Gasket EPDM	Gamitură EPDM

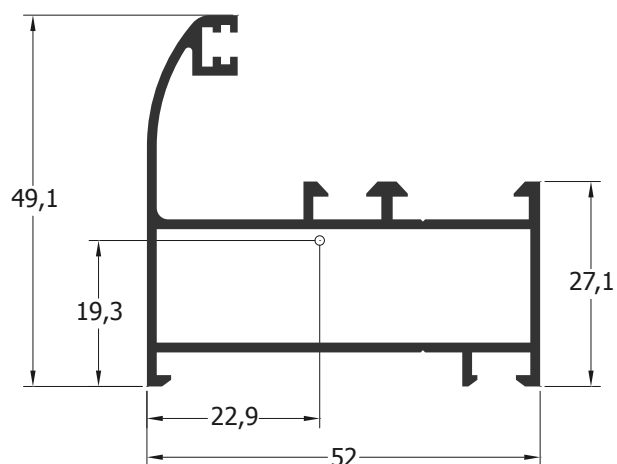

profile code cod profil	theor. weight greutate	length lungime
<b>52 - 214</b>	786 gr/m	6 m
<b>X,Y</b>	x= 52 mm    y= 49.1 mm	
<b>moments of inertia (Ix , Iy) moment de inerție</b>		
Ix= 5.25 (cm <sup>4</sup> )		Iy= 10.02 (cm <sup>4</sup> )
<b>moments of resistance (Wx , Wy) moment de rezistență</b>		
Wx= 1.76 (cm <sup>3</sup> )		Wy= 3.44 (cm <sup>3</sup> )
<b>accessories accesorii</b>		
AA052-119 or AA052-014 or AA052-071	Comer joint	Colțar
	Comer joint	Colțar
	Press comer joint	Colțar sertizare
AA052-047 or AA052-048	Alignment comer	Colțar aliniere
	Inox alignment comer	Colțar aliniere inox
AA052-004	Gasket central EPDM	Gamitură centrală EPDM
AA052-097	Vulcanized comer gasket	Colțar vulcanizat
AA052-554	Plug for drainage	Capac drenaj
AA052-006	Gasket EPDM	Gamitură EPDM



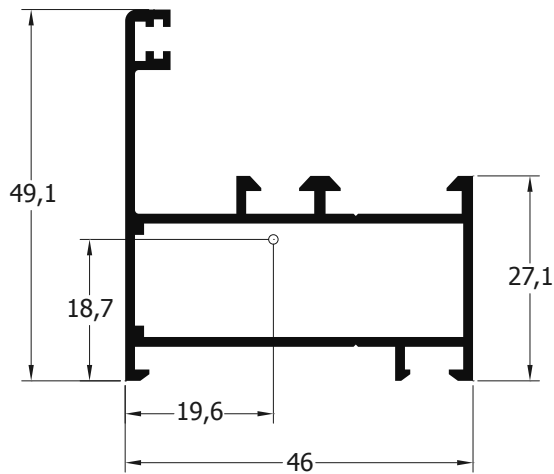

profile code cod profil	theor. weight greutate	length lungime
<b>52 - 216</b>	728 gr/m	6 m
<b>X,Y</b>	x= 46 mm    y= 49.1 mm	
<b>moments of inertia (Ix , Iy) moment de inerție</b>		
Ix= 4.54 (cm <sup>4</sup> )		Iy= 18.7 (cm <sup>4</sup> )
<b>moments of resistance (Wx , Wy) moment de rezistență</b>		
Wx= 1.49 (cm <sup>3</sup> )		Wy= 2.93 (cm <sup>3</sup> )
<b>accessories accesorii</b>		
AA052-119 or	Comer joint	Colțar
AA052-016 or	Comer joint	Colțar
AA052-070	Press comer joint	Colțar sertizare
AA052-047 or	Alignment comer	Colțar aliniere
AA052-048	Inox alignment comer	Colțar aliniere inox
AA052-004	Gasket central EPDM	Garnitură centrală EPDM
AA052-097	Vulcanized comer gasket	Colțar vulcanizat
AA052-554	Plug for drainage	Capac drenaj
AA052-006	Gasket EPDM	Garnitură EPDM

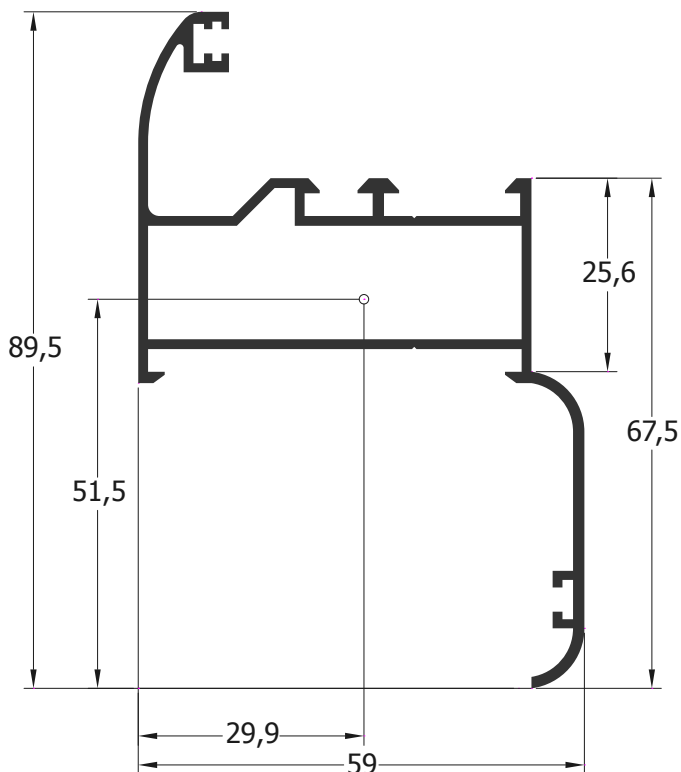

profile code cod profil	theor. weight greutate	length lungime
<b>52 - 208</b>	991 gr/m	6 m
<b>X,Y</b>	x= 59 mm    y= 89.5 mm	
<b>moments of inertia (Ix , Iy) moment de inerție</b>		
Ix= 4.26 (cm <sup>4</sup> )		Iy= 7.1 (cm <sup>4</sup> )
<b>moments of resistance (Wx , Wy) moment de rezistență</b>		
Wx= 3.21 (cm <sup>3</sup> )		Wy= 5.97 (cm <sup>3</sup> )
<b>accessories accesorii</b>		
AA052-119 or	Comer joint	Colțar
AA052-014 or	Comer joint	Colțar
AA052-071	Press comer joint	Colțar sertizare
AA052-047 or	Alignment comer	Colțar aliniere
AA052-048	Inox alignment comer	Colțar aliniere inox
AA052-004	Gasket central EPDM	Garnitură centrală EPDM
AA052-097	Vulcanized comer gasket	Colțar vulcanizat
AA052-554	Plug for drainage	Capac drenaj
AA052-006	Gasket EPDM	Garnitură EPDM

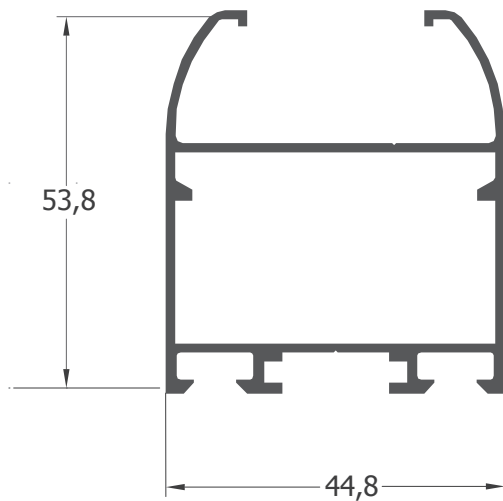

profile code cod profil	theor. weight greutate	length lungime
<b>48 - 303</b>	897 gr/m	6 m
<b>X,Y</b>	x= 47.5 mm    y= 53.8 mm	
<b>moments of inertia (Ix , Iy) moment de inerție</b>		
Ix= 9.35 (cm <sup>4</sup> )	Iy= 10.78 (cm <sup>4</sup> )	
<b>moments of resistance (Wx , Wy) moment de rezistență</b>		
Wx= 2.96 (cm <sup>3</sup> )	Wy= 4.54 (cm <sup>3</sup> )	
<b>accessories accesorii</b>		
AA048-021	Corner joint	Colțar
AA048-004	Sash gasket	Gamitură cercevea
AA048-006	Gasket EPDM	Gamitură EPDM
AA048-104	Hinge	Balama
AA048-100	Double hinge and sliding roller	Balama dublă cu role glisare
AA048-101	Single hinge and sliding roller	Balama simplă cu role glisare
AA048-102	Double hinge and roller for alignment	Balama dublă cu role aliniere
AA048-103	Single hinge and roller for alignment	Balama simplă cu role aliniere

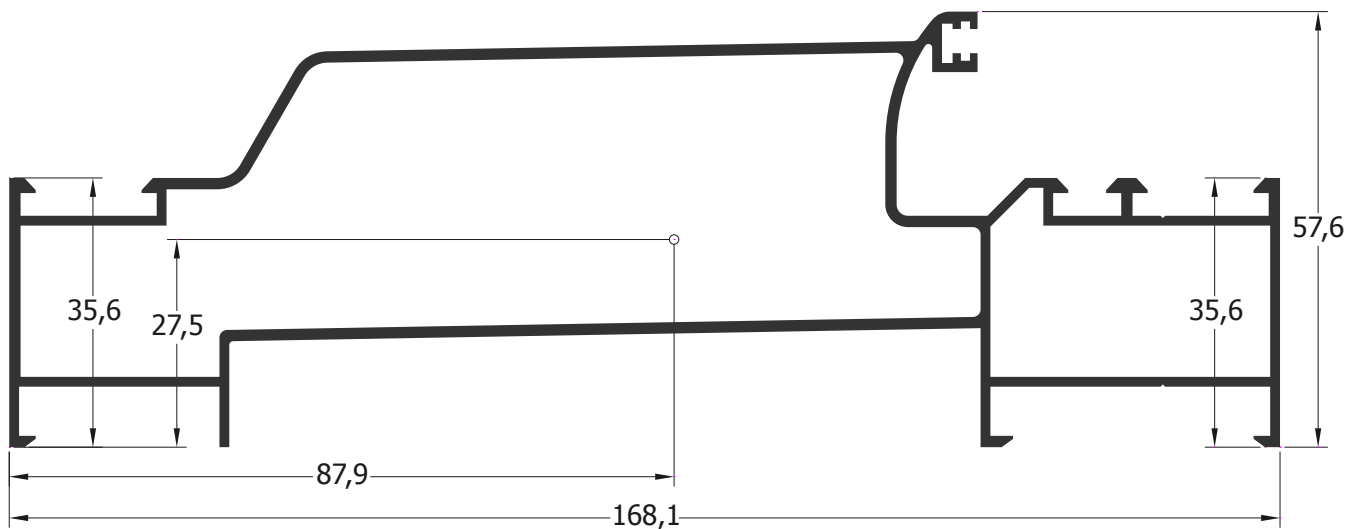

profile code cod profil	theor. weight greutate	length lungime	<b>accessories accesorii</b>		
<b>52 - 212</b>	2045 gr/m	6m	AA052-015	Corner joint	Colțar
<b>X,Y</b>	x= 168 mm    y= 49.1 mm		AA055-021	Corner joint	Colțar
<b>moments of inertia (Ix , Iy) moment de inerție</b>			AA052-047 or AA052-048	Alignment corner Inox alignment corner	Colțar aliniere Colțar aliniere inox
Ix= 20.74 (cm <sup>4</sup> )	Iy= 215.43 (cm <sup>4</sup> )		AA052-004	Gasket central EPDM	Gamitură centrală EPDM
<b>moments of resistance (Wx , Wy) moment de rezistență</b>			AA052-097	Vulcanized corner gasket	Colțar vulcanizat
Wx= 6.89 (cm <sup>3</sup> )	Wy= 24.51 (cm <sup>3</sup> )		AA052-006	Gasket EPDM	Gamitură EPDM



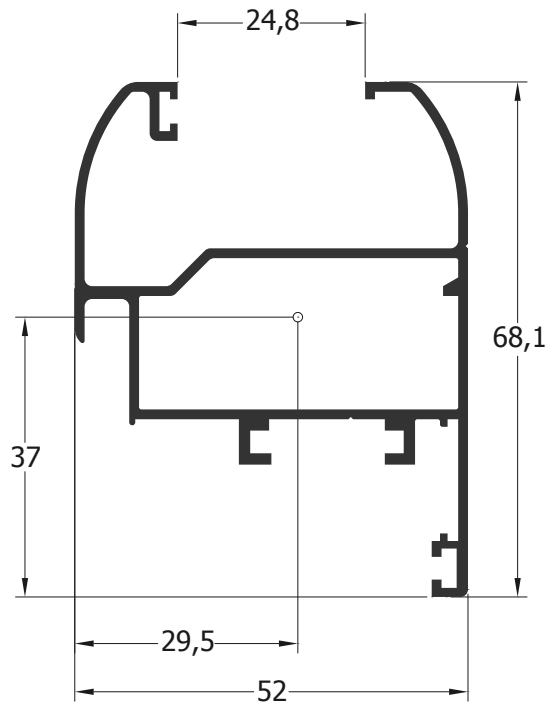

profile code cod profil	theor. weight greutate	length lungime
<b>52 - 313</b>	982 gr/m	6 m
<b>X,Y</b>	x= 52 mm    y= 68.1 mm	
<b>moments of inertia (Ix , Iy) moment de inerție</b>		
Ix= 11.19 (cm <sup>4</sup> )	Iy= 12.98 (cm <sup>4</sup> )	
<b>moments of resistance (Wx , Wy) moment de rezistență</b>		
Wx= 3.02 (cm <sup>3</sup> )	Wy= 4.4 (cm <sup>3</sup> )	
<b>accessories accesorii</b>		
AA052-116	Comer joint	Colțar
AA052-047 or AA052-048	Alignment comer Inox alignment comer	Colțar aliniere Colțar aliniere inox
AA052-049 or AA052-046	Alignment comer joint Inox alignment comer	Colțar aliniere Colțar aliniere inox
AA052-006	Gasket EPDM	Gamitură EPDM

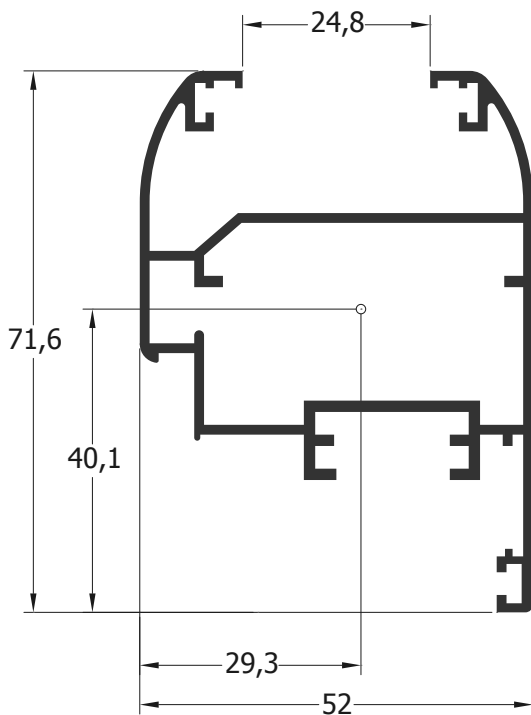

profile code cod profil	theor. weight greutate	length lungime
<b>52 - 307</b>	1115 gr/m	6 m
<b>X,Y</b>	x= 52 mm    y= 71.6 mm	
<b>moments of inertia (Ix , Iy) moment de inerție</b>		
Ix= 14.76 (cm <sup>4</sup> )	Iy= 14.94 (cm <sup>4</sup> )	
<b>moments of resistance (Wx , Wy) moment de rezistență</b>		
Wx= 3.69 (cm <sup>3</sup> )	Wy= 5.1 (cm <sup>3</sup> )	
<b>accessories accesorii</b>		
AA052-016	Comer joint	Colțar
AA052-047 or AA052-048	Alignment comer Inox alignment comer	Colțar aliniere Colțar aliniere inox
AA052-049 or AA052-046	Alignment comer joint Inox alignment comer	Colțar aliniere Colțar aliniere inox
AA052-006	Gasket EPDM	Gamitură EPDM

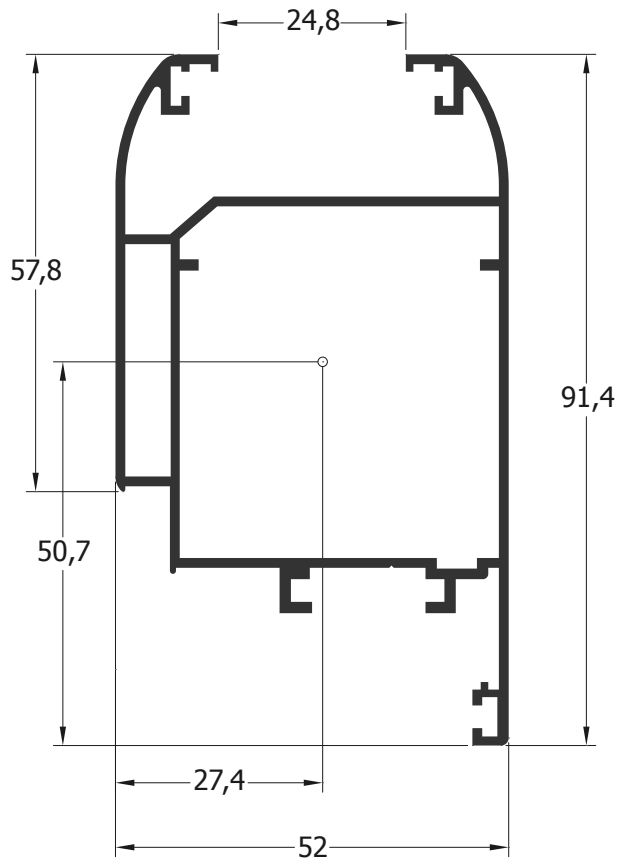

profile code cod profil	theor. weight greutate	length lungime
<b>52 - 308</b>	1286 gr/m	6 m
<b>X,Y</b>	x= 52 mm    y= 91.4 mm	
<b>moments of inertia (Ix , Iy) moment de inerție</b>		
Ix= 31.95 (cm <sup>4</sup> )		Iy= 18.08 (cm <sup>4</sup> )
<b>moments of resistance (Wx , Wy) moment de rezistență</b>		
Wx= 6.29 (cm <sup>3</sup> )		Wy= 6.30 (cm <sup>3</sup> )
<b>accessories accesorii</b>		
AA052-116	Corner joint	Colțar
AA052-047 or AA052-048	Alignment corner Inox alignment corner	Colțar aliniere Colțar aliniere inox
AA052-049 or AA052-046	Alignment corner joint Inox alignment corner	Colțar aliniere Colțar aliniere inox
AA052-006	Gasket EPDM	Garnitură EPDM
AA052-018	Adaptor for corner joint	Adaptor colțar

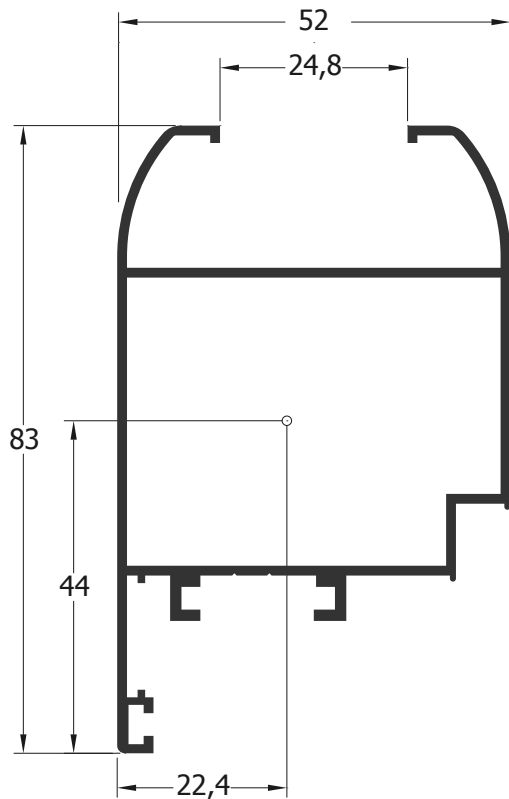

profile code cod profil	theor. weight greutate	length lungime
<b>52 - 309</b>	1033 gr/m	6 m
<b>X,Y</b>	x= 52 mm    y= 83 mm	
<b>moments of inertia (Ix , Iy) moment de inerție</b>		
Ix= 20.84 (cm <sup>4</sup> )		Iy= 15 (cm <sup>4</sup> )
<b>moments of resistance (Wx , Wy) moment de rezistență</b>		
Wx= 4.74 (cm <sup>3</sup> )		Wy= 5.07 (cm <sup>3</sup> )
<b>accessories accesorii</b>		
AA052-016	Corner joint	Colțar
AA052-049 or AA052-046	Alignment corner joint Inox alignment corner	Colțar aliniere Colțar aliniere inox
AA052-006	Gasket EPDM	Garnitură EPDM
AA052-019	Adaptor for corner joint	Adaptor colțar



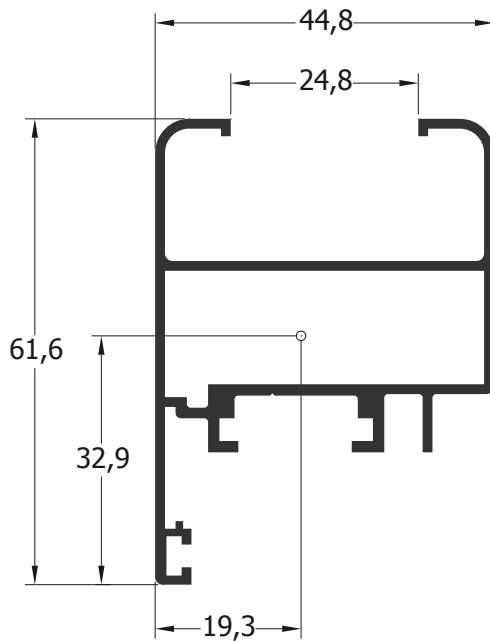

profile code cod profil	theor. weight greutate	length lungime
<b>52 - 310</b>	892 gr/m	6 m
<b>X,Y</b>	x= 44.8 mm	y= 61.6 mm
<b>moments of inertia (Ix , Iy) moment de inerție</b>		
Ix= 7.84 (cm <sup>4</sup> )		Iy= 9.07 (cm <sup>4</sup> )
<b>moments of resistance (Wx , Wy) moment de rezistență</b>		
Wx= 2.38 (cm <sup>3</sup> )		Wy= 3.55 (cm <sup>3</sup> )
<b>accessories accesorii</b>		
AA052-016	Comer joint	Colțar
AA052-049 or	Alignment comer joint	Colțar aliniere
AA052-046	Inox alignment comer	Colțar aliniere inox
AA052-006	Gasket EPDM	Garnitură EPDM

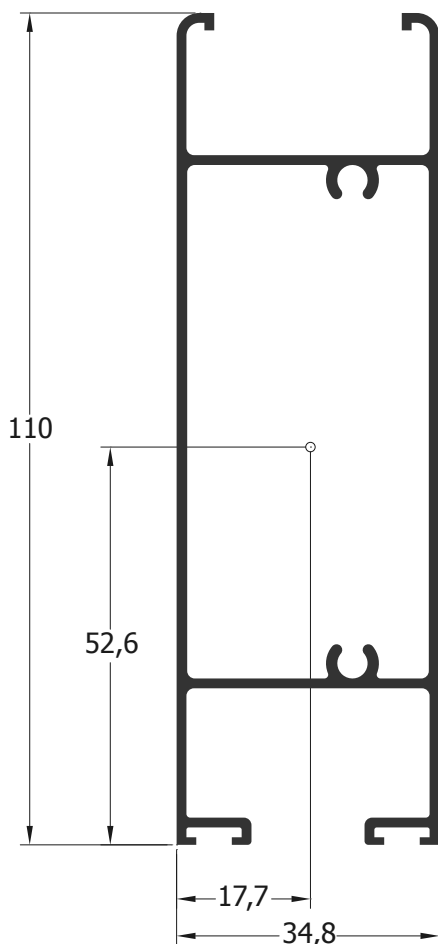

profile code cod profil	theor. weight greutate	length lungime
<b>52 - 409</b>	1234 gr/m	6 m
<b>X,Y</b>	x= 34.8 mm	y= 110 mm
<b>moments of inertia (Ix , Iy) moment de inerție</b>		
Ix= 54.3 (cm <sup>4</sup> )		Iy= 9.84 (cm <sup>4</sup> )
<b>moments of resistance (Wx , Wy) moment de rezistență</b>		
Wx= 9.45 (cm <sup>3</sup> )		Wy= 5.55 (cm <sup>3</sup> )
<b>accessories accesorii</b>		
AA331-008-02-02	Brush	Perie

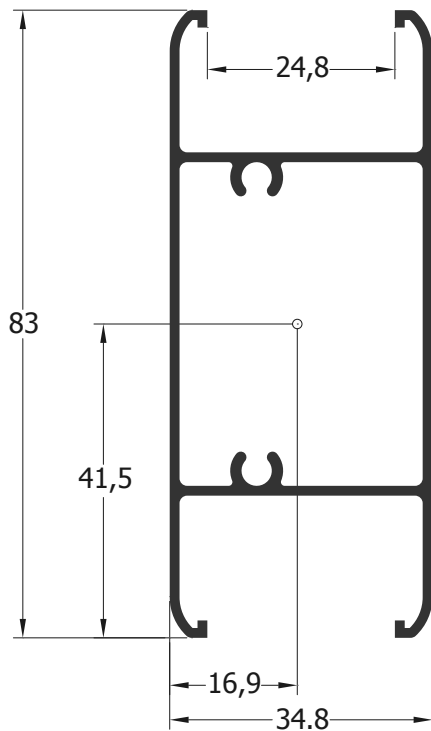

profile code cod profil	theor. weight greutate	length lungime
<b>52 - 407</b>	937 gr/m	6 m
<b>X,Y</b>	x= 34.8 mm    y= 83 mm	
<b>moments of inertia (Ix , Iy) moment de inerție</b>		
Ix= 20.30 (cm <sup>4</sup> )	Iy= 7.14 (cm <sup>4</sup> )	
<b>moments of resistance (Wx , Wy) moment de rezistență</b>		
Wx= 4.95 (cm <sup>3</sup> )	Wy= 4.2 (cm <sup>3</sup> )	

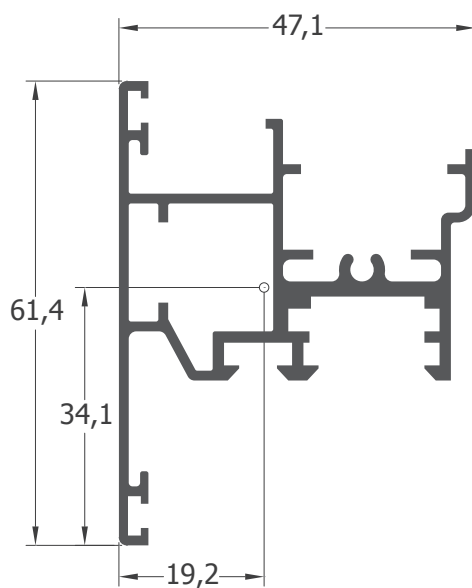

profile code cod profil	theor. weight greutate	length lungime
<b>52 - 544</b>	987 gr/m	6 m
<b>X,Y</b>	x= 47.1 mm    y= 61.4 mm	
<b>moments of inertia (Ix , Iy) moment de inerție</b>		
Ix= 6.03 (cm <sup>4</sup> )	Iy= 8.88 (cm <sup>4</sup> )	
<b>moments of resistance (Wx , Wy) moment de rezistență</b>		
Wx= 1.77 (cm <sup>3</sup> )	Wy= 3.18 (cm <sup>3</sup> )	
<b>accessories accesorii</b>		
AA052-006	Gasket EPDM	Garnitură EPDM
AA052-544	Plastic plug for 52-544	Capac plastic
AA052-004	Gasket central EPDM	Garnitură centrală EPDM

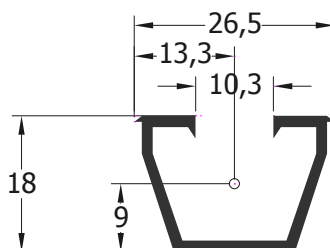
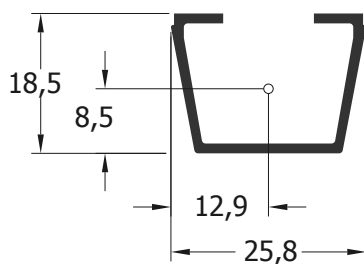
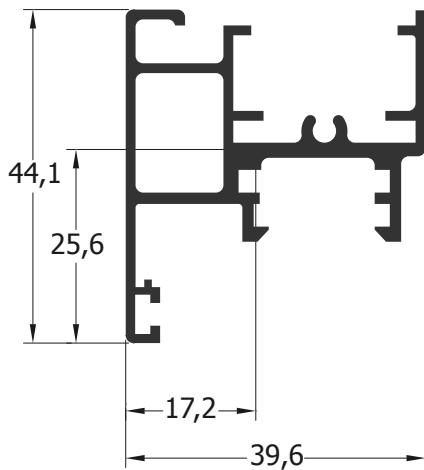
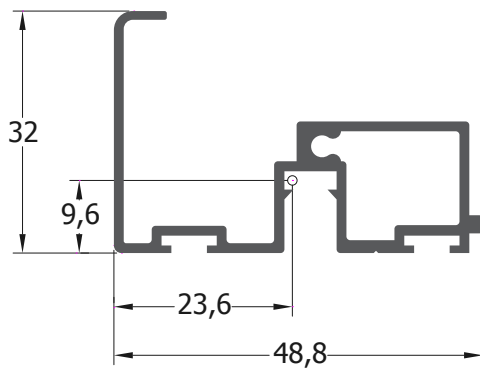

profile code cod profil	theor. weight greutate	length lungime
<b>52 - 539</b>	597 gr/m	6 m
<b>X,Y</b>	x= 48.8 mm	y= 32 mm
<b>moments of inertia (Ix , Iy) moment de inerție</b>		
Ix= 1.51 (cm <sup>4</sup> )		Iy= 5.67 (cm <sup>4</sup> )
<b>moments of resistance (Wx , Wy) moment de rezistență</b>		
Wx= 0.67 (cm <sup>3</sup> )		Wy= 2.25 (cm <sup>3</sup> )
<b>accessories accesorii</b>		
AA331-007	Brush No 7	Perie nr. 7
AA052-022	Gasket for bottom rail	Garnitură pentru bandou
AA052-539	Plastic plug for 52-539	Capac drenaj

profile code cod profil	theor. weight greutate	length lungime
<b>52 - 536</b>	793 gr/m	6 m
<b>X,Y</b>	x= 39.6 mm	y= 44.1 mm
<b>moments of inertia (Ix , Iy) moment de inerție</b>		
Ix= 2.94 (cm <sup>4</sup> )		Iy= 5.42 (cm <sup>4</sup> )
<b>moments of resistance (Wx , Wy) moment de rezistență</b>		
Wx= 1.16 (cm <sup>3</sup> )		Wy= 2.43 (cm <sup>3</sup> )
<b>accessories accesorii</b>		
AA052-006	Gasket EPDM	Garnitură EPDM
AA052-536	Plastic plug for 52-536	Capac plastic

profile code cod profil	theor. weight greutate	length lungime
<b>35 - 509</b>	233 gr/m	6 m
<b>X,Y</b>	x= 25.8 mm	y= 18.5 mm
<b>moments of inertia (Ix , Iy) moment de inerție</b>		
Ix= 0.4 (cm <sup>4</sup> )		Iy= 0.75 (cm <sup>4</sup> )
<b>moments of resistance (Wx , Wy) moment de rezistență</b>		
Wx= 0.4 (cm <sup>3</sup> )		Wy= 0.58 (cm <sup>3</sup> )

profile code cod profil	theor. weight greutate	length lungime
<b>52 - 523</b>	254 gr/m	6 m
<b>X,Y</b>	x= 26.5 mm	y= 18 mm
<b>moments of inertia (Ix , Iy) moment de inerție</b>		
Ix= 0.42 (cm <sup>4</sup> )		Iy= 0.72 (cm <sup>4</sup> )
<b>moments of resistance (Wx , Wy) moment de rezistență</b>		
Wx= 0.46 (cm <sup>3</sup> )		Wy= 0.54 (cm <sup>3</sup> )

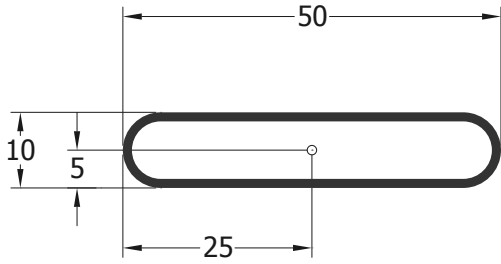

profile code cod profil	theor. weight greutate	length lungime
<b>10 - 302</b>	349 gr/m	6 m
<b>X,Y</b>	x= 50 mm    y= 10 mm	
<b>moments of inertia (Ix , Iy) moment de inerție</b>		
Ix= 0.21 (cm <sup>4</sup> )	Iy= 3.01 (cm <sup>4</sup> )	
<b>moments of resistance (Wx , Wy) moment de rezistență</b>		
Wx= 0.42 (cm <sup>3</sup> )	Wy= 1.20 (cm <sup>3</sup> )	

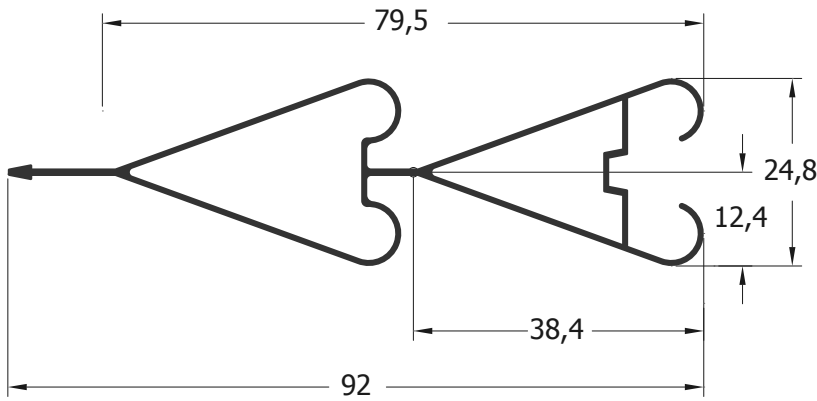

profile code cod profil	theor. weight greutate	length lungime
<b>10 - 300</b>	597 gr/m	6 m
<b>X,Y</b>	x= 24.8 mm    y= 90.6 mm	
<b>moments of inertia (Ix , Iy) moment de inerție</b>		
Ix= 13.19 (cm <sup>4</sup> )	Iy= 0.91 (cm <sup>4</sup> )	
<b>moments of resistance (Wx , Wy) moment de rezistență</b>		
Wx= 2.46 (cm <sup>3</sup> )	Wy= 0.73 (cm <sup>3</sup> )	

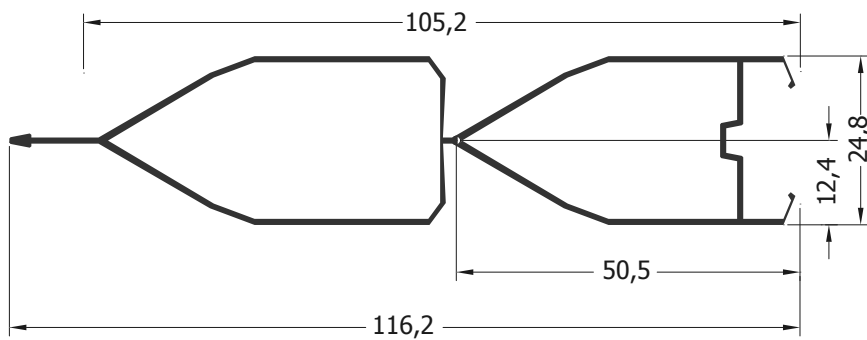

profile code cod profil	theor. weight greutate	length lungime
<b>10 - 304</b>	708 gr/m	6 m
<b>X,Y</b>	x= 24.8 mm    y= 116 mm	
<b>moments of inertia (Ix , Iy) moment de inerție</b>		
Ix= 27.66 (cm <sup>4</sup> )	Iy= 2.14 (cm <sup>4</sup> )	
<b>moments of resistance (Wx , Wy) moment de rezistență</b>		
Wx= 4.21 (cm <sup>3</sup> )	Wy= 1.73 (cm <sup>3</sup> )	

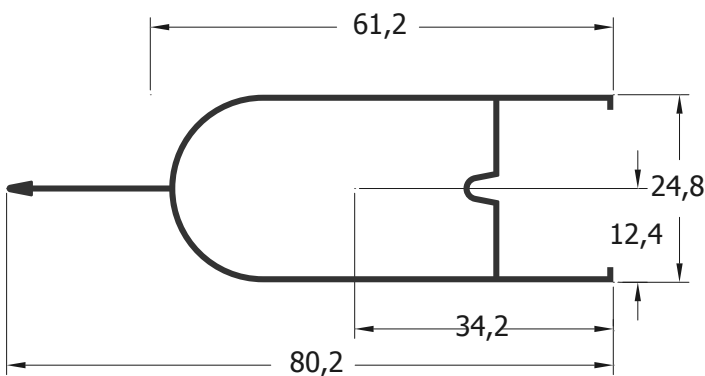

profile code cod profil	theor. weight greutate	length lungime
<b>10 - 301</b>	449 gr/m	6 m
<b>X,Y</b>	x= 24.8 mm    y= 80.2 mm	
<b>moments of inertia (Ix , Iy) moment de inerție</b>		
Ix= 7.07 (cm <sup>4</sup> )	Iy= 1.39 (cm <sup>4</sup> )	
<b>moments of resistance (Wx , Wy) moment de rezistență</b>		
Wx= 1.54 (cm <sup>3</sup> )	Wy= 1.12 (cm <sup>3</sup> )	



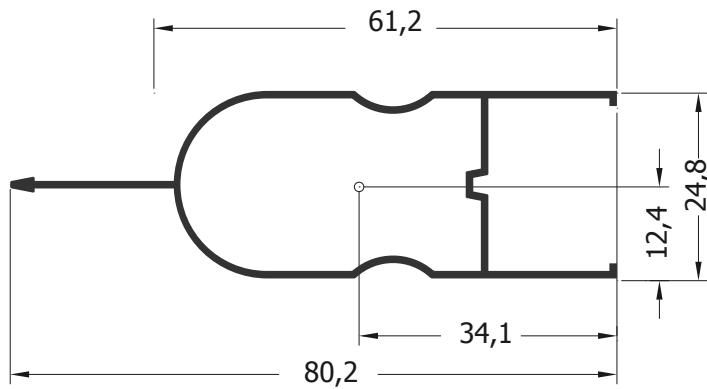

profile code cod profil	theor. weight greutate	length lungime
<b>10 - 303</b>	488 gr/m	6 m
<b>X,Y</b>	x= 24.8 mm    y= 80.2 mm	
<b>moments of inertia (Ix , Iy) moment de inerție</b>		
Ix= 8.19 (cm <sup>4</sup> )	Iy= 1.65 (cm <sup>4</sup> )	
<b>moments of resistance (Wx , Wy) moment de rezistență</b>		
Wx= 1.77 (cm <sup>3</sup> )	Wy= 1.33 (cm <sup>3</sup> )	

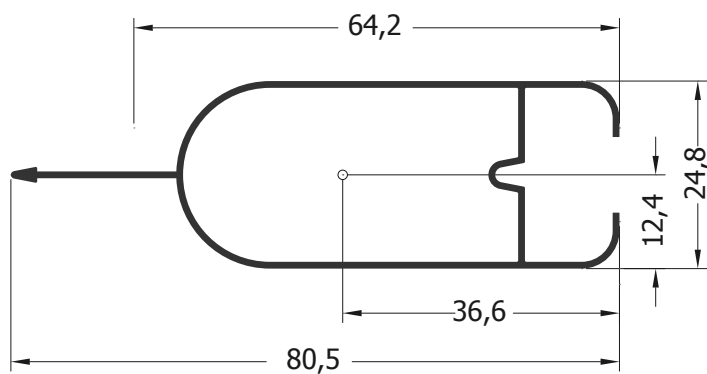

profile code cod profil	theor. weight greutate	length lungime
<b>10 - 306</b>	466 gr/m	6 m
<b>X,Y</b>	x= 24.8 mm    y= 80.5 mm	
<b>moments of inertia (Ix , Iy) moment de inerție</b>		
Ix= 8.73 (cm <sup>4</sup> )	Iy= 1.55 (cm <sup>4</sup> )	
<b>moments of resistance (Wx , Wy) moment de rezistență</b>		
Wx= 1.82 (cm <sup>3</sup> )	Wy= 1.25 (cm <sup>3</sup> )	

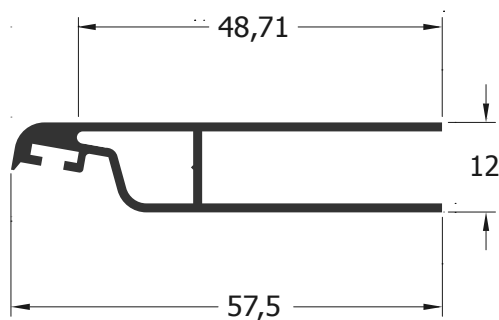

profile code cod profil	theor. weight greutate	length lungime
<b>10 - 310</b>	461 gr/m	6 m
<b>X,Y</b>	x= 57.5 mm    y= 12 mm	
<b>moments of inertia (Ix , Iy) moment de inerție</b>		
Ix= 0.37 (cm <sup>4</sup> )	Iy= 4.63 (cm <sup>4</sup> )	
<b>moments of resistance (Wx , Wy) moment de rezistență</b>		
Wx= 0.54 (cm <sup>3</sup> )	Wy= 1.47 (cm <sup>3</sup> )	

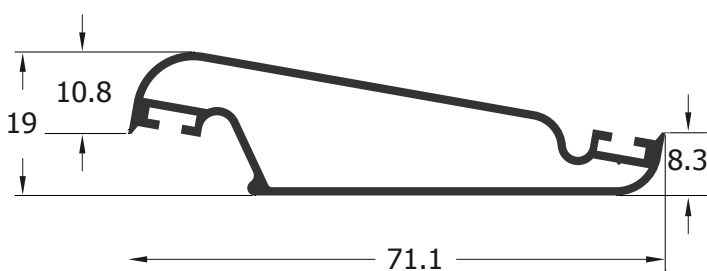

profile code cod profil	theor. weight greutate	length lungime
<b>10 - 311</b>	535 gr/m	6 m
<b>X,Y</b>	x= 71.1 mm    y= 19 mm	
<b>moments of inertia (Ix , Iy) moment de inerție</b>		
Ix= 0.72 (cm <sup>4</sup> )	Iy= 9.70 (cm <sup>4</sup> )	
<b>moments of resistance (Wx , Wy) moment de rezistență</b>		
Wx= 0.65 (cm <sup>3</sup> )	Wy= 2.66 (cm <sup>3</sup> )	

Mobile shutter with fixed blades // Oblon mobil cu lamele fixe

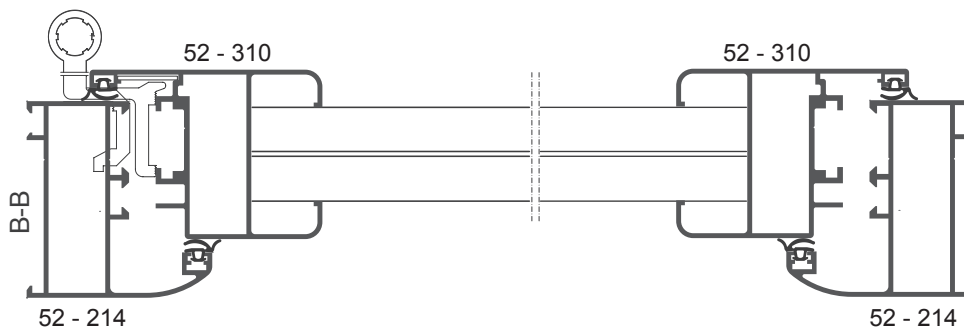
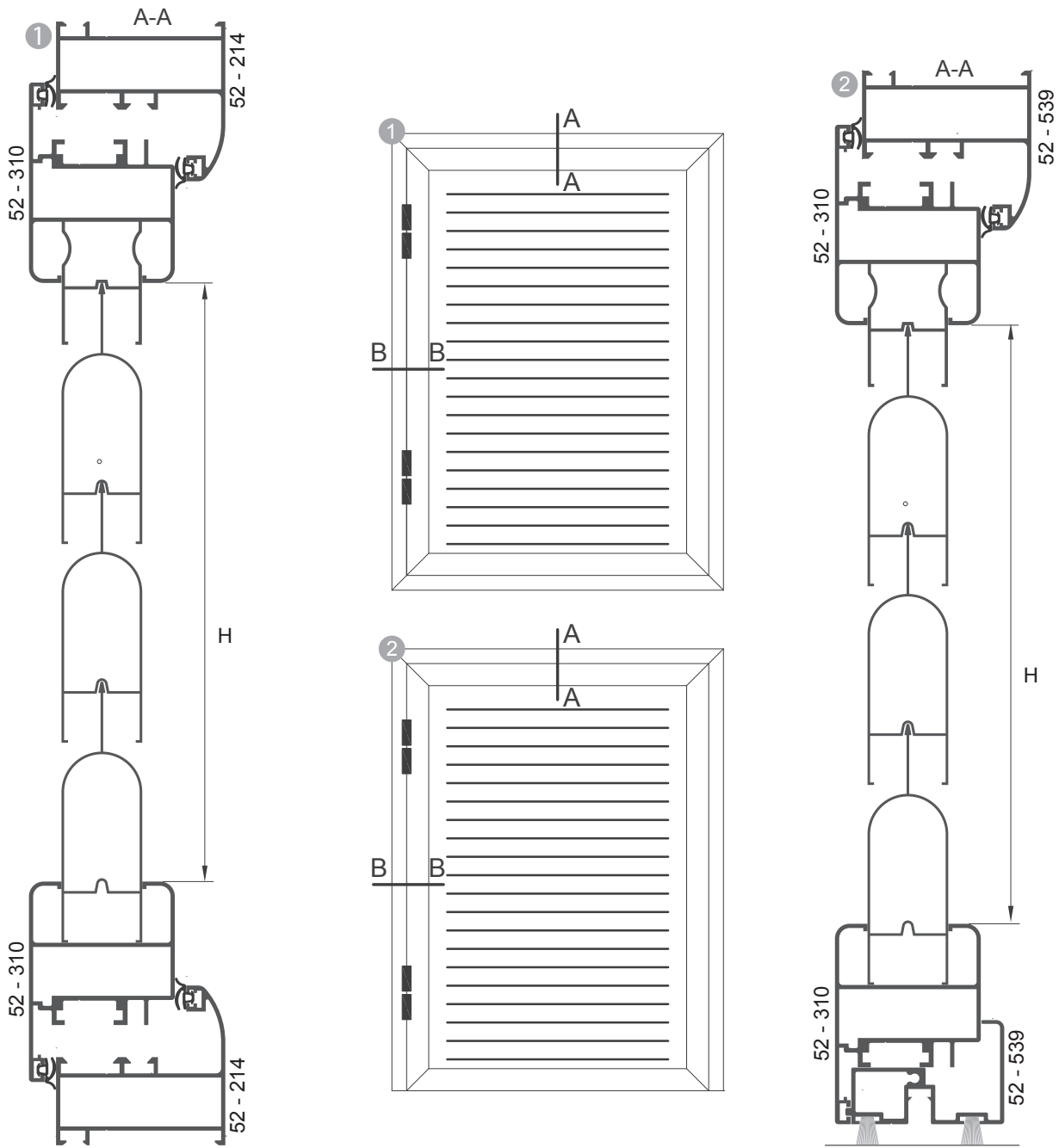

Mobile shutter with ajustable blades // Oblon mobil cu lamele reglabile

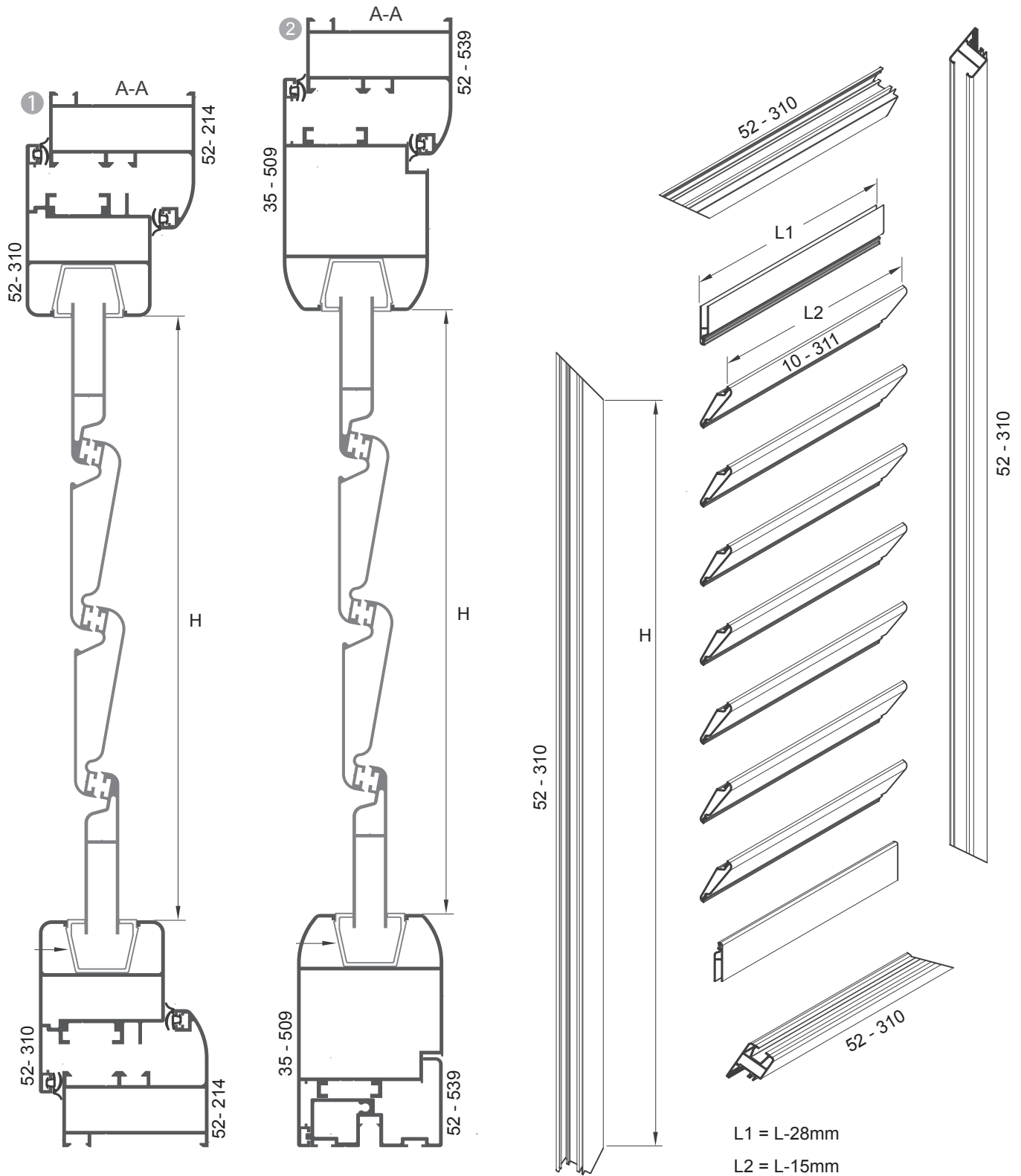

## Mobile shutter with fixed blades // Oblon uşă

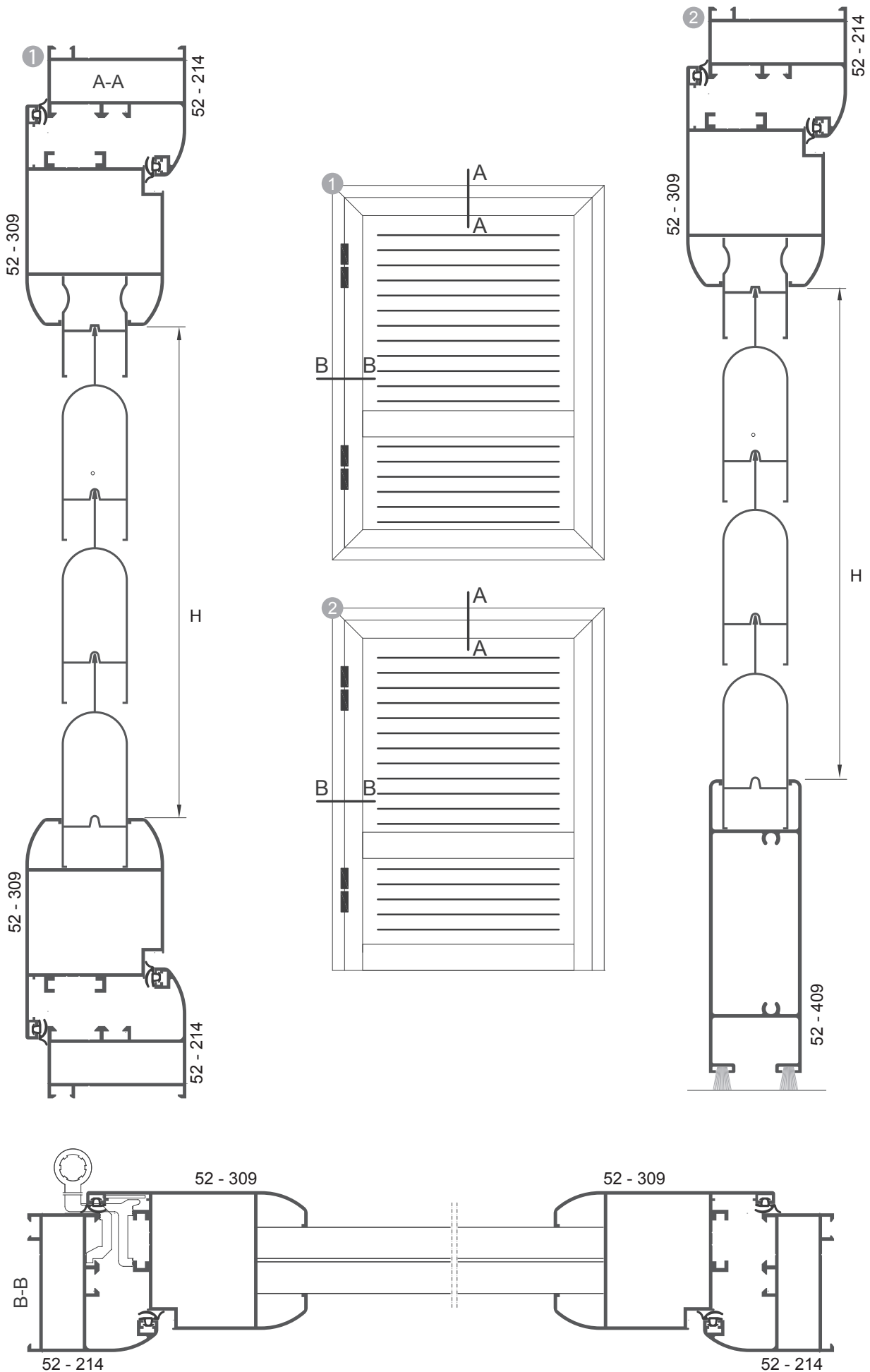



Window with shutter // Fereastra cu oblon

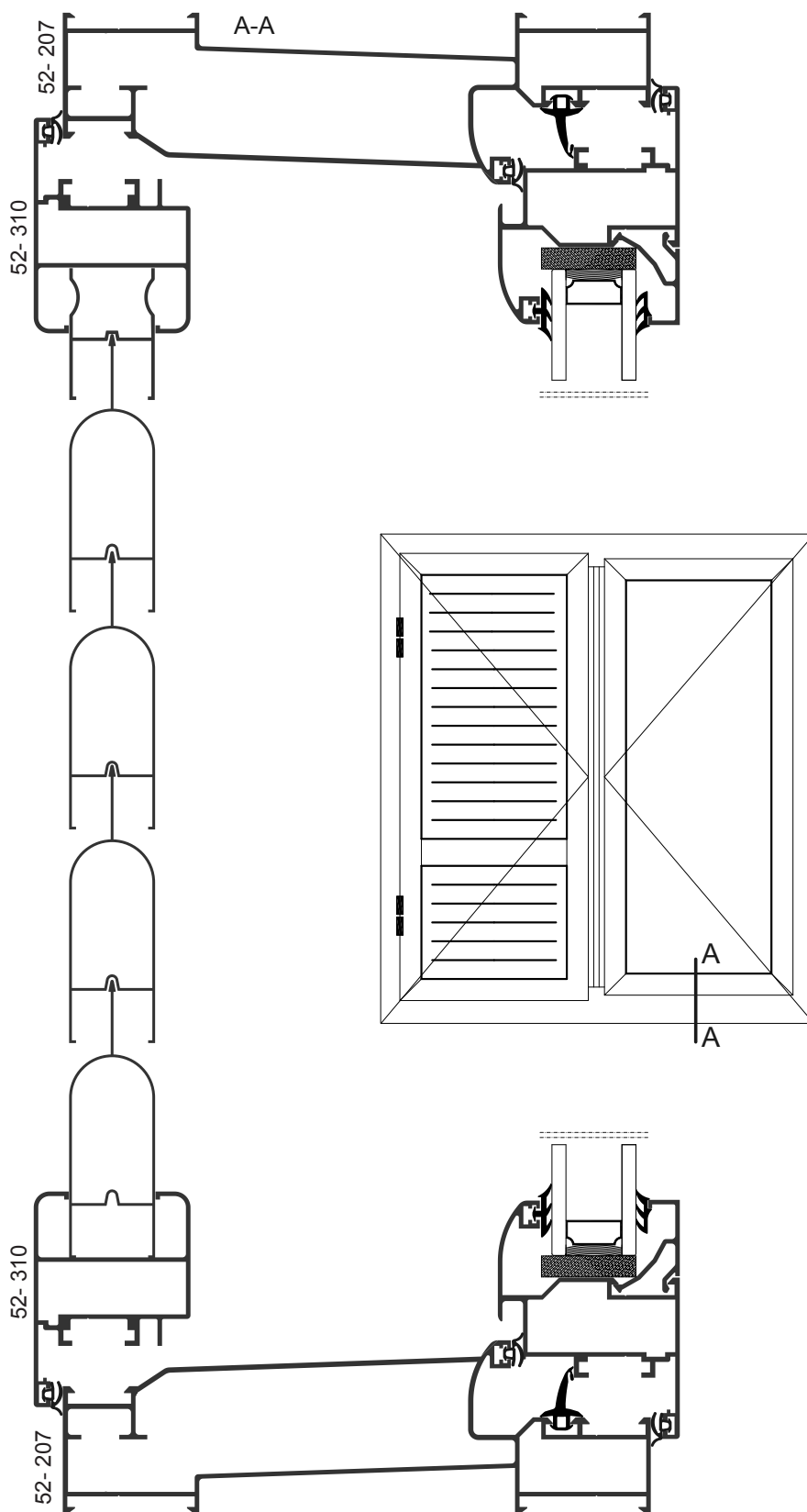

Fix shutter with adjustable blades // Oblon fix cu lamele reglabile

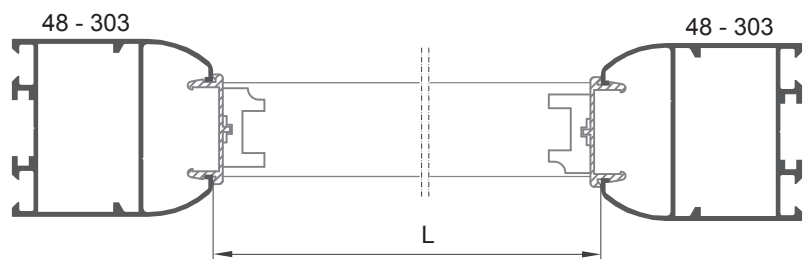
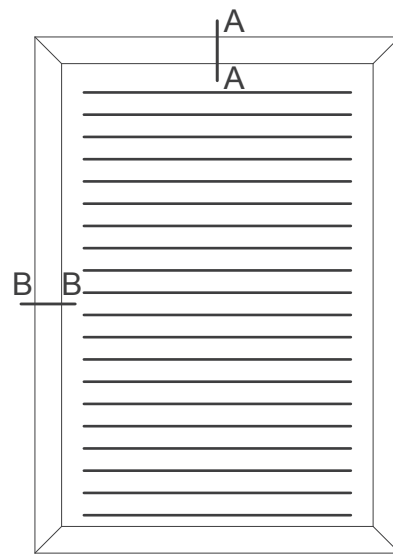
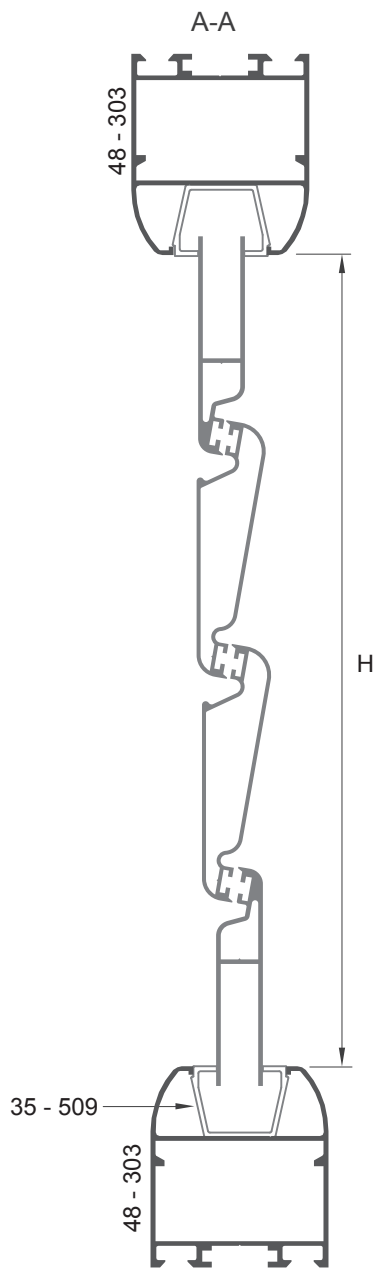



**AA112-001-01**  
Hinge for shutter 52mm CE  
Balama oblon 52mm CE  
colors / culori: ○ ●



**AA112-003-01**  
Hinge for shutter 142mm CE  
Balama oblon 142mm CE  
colors / culori: ○ ●



**AA112-019-01**  
Hinge for shutter 220mm CE  
Balama oblon 220mm CE  
colors / culori: ○ ●



**AA112-004-01**  
Hinge for shutter 182mm CE  
Balama oblon 52 mm CE  
colors / culori: ○ ●



**AA206-013-02**  
Plug plastic for shutters  
Capac lamelă 302  
colors / culori: ●



**AA206-019-00**  
Plug plastic for shutters double  
Capac lamelă 302  
colors / culori: ●



**AA107-033-01**  
Cremone for shutter (550)  
Cremon oblon  
colors / culori: ○ ●



**AA217-002-02**  
Shutter stop double black  
Stoper dublu  
colors / culori: ●



**AA200-009-01**  
Handle for seal block  
Mâner pentru oblon  
colors / culori: ●



**AA107-013-01**  
Cremone bolt for shutter (550)  
Cremon oblon  
colors / culori: ○ ●



**AA217-004-02**  
Shutter stop simple  
Stoper simplu  
colors / culori: ●



**AA200-008-02**  
Additional locking point for cremon  
Cuib pentru cremon aplicat  
colors / culori: ●



**AA218-005-00**  
Gasket for 10-310 / 10-311  
Garnitură pentru 10-310 / 10-311  
colors / culori: ●



**AA200-004-02**

Seal block complete 1,5 m  
Cremon aplicat oblon 1,5 m  
colors / culori: ○ ●



**AA218-200-00**

Handle for variable shutters  
Mâner pentru oblon  
colors / culori: ●

**AA200-006-02**

Seal block complete 2,3 m  
Cremon aplicat oblon 1,5 m  
colors / culori: ○ ●



**AA218-201-00**

Right handle for variable shutters  
Mâner pentru oblon - desc. dreapta  
colors / culori: ●



**AA218-202-00**

Left handle for variable shutters  
Mâner pentru oblon - desc. stânga  
colors / culori: ●

Mecanism reglare lamele  
colors / culori: ●



CODE COD	No of LOUVER Nr. de LAMELE	LENGTH LUNGIME
AA218-100	6	459
AA218-101	7	519
AA218-102	8	579
AA218-103	9	639
AA218-104	10	699
AA218-105	11	759
AA218-106	12	819
AA218-107	13	879
AA218-108	14	939
AA218-109	15	999
AA218-110	16	1059
AA218-111	17	1119
AA218-112	18	1179
AA218-113	19	1239
AA218-114	20	1299
AA218-115	21	1359
AA218-116	22	1419
AA218-117	23	1479
AA218-118	24	1539
AA218-119	25	1599
AA218-120	26	1659
AA218-121	27	1719
AA218-122	28	1779
AA218-123	29	1839
AA218-124	30	1899
AA218-125	31	1959
AA218-126	32	2019
AA218-127	33	2079







PROFILCO GR - INOFITA



PROFILCO GR NEW OFFICE - INOFITA



PROFILCO YU - BEOGRAD



PROFILCO BG - SOFIA

## SALES NETWORK - ΔΙΚΤΥΟ ΠΩΛΗΣΕΩΝ

### ΕΛΛΑΔΑ : PROFILCO GR

Οινόφυτα 53ο χλμ. Ε.Ο. Αθηνών - Λαμίας, Τ.Κ. 320 11, Οινόφυτα Βοιωτίας,  
τηλ.: (22620) 31753-4, fax: (22620) 30953, e-mail: info@profilco.gr, w: www.profilco.gr

Μεταμόρφωση 12ο χλμ. Ε.Ο. Αθηνών - Λαμίας, Τ.Κ. 144 52,  
τηλ.: (210) 2831159, fax: (210) 2831171, e-mail: metamorfosi@profilco.gr

Λαμία 3ο χλμ. Νέα Εθνική Οδό Λαμίας - Αθηνών, Τ.Κ. 351 00,  
τηλ.: (22310) 45210, fax: (22310) 45211, e-mail: lamia@profilco.gr

Ιωάννινα 7ο χλμ. Ε.Ο. Ιωαννίνων - Αθηνών, Τ.Κ. 455 00  
τηλ.: (26510) 94762, fax: (26510) 94763, e-mail: ioannina@profilco.gr

Κρήτη Μάνου Κατράκη 27, Τ.Κ. 715 00 Φοινικιά, Ηράκλειο Κρήτης,  
τηλ.: (2810) 528080, fax: (2810) 528032, e-mail: crete@profilco.gr

Καζαντζάκη 189, Δημοτικό διαμέρισμα Βαμβακόπουλου, Δημοτικής ενότητας Θερίσου  
Τ.Κ. 731 34, Χανιά Κρήτης  
τηλ.: (28210) 02500, fax: (28210) 02152, e-mail: chania@profilco.gr

### ROMÂNIA : PROFILCO RO SRL

București Bulevardul Preciziei, Nr 30, Hala Industriala Nr 2, Sector 6, Bucuresti,  
tel: (+40) 21 3501956, 21 3501958 fax: (+40) 21 3501943 e-mail: office@profilco-romania.ro

Brasov Str. Zizinului, Nr 106A, Hala F3 (Complex Duplex) Jud Braşov, Braşov  
tel: (+40) 268 549 136, fax: (+40) 268 549 135, e-mail: brasov@profilco-romania.ro

Bacău Calea Romanului Nr 5, Jud Bacău  
tel: (+40) 234 545 471, fax: (+40) 234 545 472, e-mail: bacau@profilco-romania.ro

Baia Mare Str. Nisiparilor Nr 27, Jud Maramureş, Baia Mare  
tel: (+40) 262 250 399, fax: (+40) 262 250 411, e-mail: baia-mare@profilco-romania.ro

Cluj Napoca Str. Muncii, Nr 8, Jud Cluj, Cluj Napoca  
tel: (+40) 264 415 444, fax: (+40) 264 415 446, e-mail: cluj@profilco-romania.ro

Constanța Str. Interioară Nr 3, Constanța (în incinta Comat)  
tel: (+40) 241 620 707, 31 228 2657 fax: (+40) 31 228 4457, e-mail: constanta@profilco-romania.ro

Craiova Str. Calea Severinului Nr 34, Jud Dolj, Craiova  
tel / fax: (+40) 251 471 074 / (+40) 251 471 002, e-mail: craiova@profilco-romania.ro

Timișoara Str. Căprioarei Nr 5, Chiroda, Jud Timiș  
tel: (+40) 256 274 005, fax: (+40) 256 274 006, e-mail: timisoara@profilco-romania.ro

Ploiești Str. Poligonului Nr 5-7, Jud Prahova,  
tel.: (+40) 344 801 211, fax: (+40) 344 801 212, e-mail: ploiesti@profilco-romania.ro

Pitești Str. Depozitelor Nr 41-43, Jud Argeş, Pitești  
tel: (+40) 348 439 421, fax: (+40) 348 439 422, e-mail: pitesti@profilco-romania.ro

Alba Iulia Str. Gării Nr 2A, Loc. Barabant, Jud Alba  
tel: (+40) 258 815 021, fax: (+40) 258 815 020, e-mail: alba-iulia@profilco-romania.ro

Arad Str. Mesterul Manole, Nr. 16, Ferma 15, Jud Arad, Arab  
tel: (+40) 257 282 830, fax: (+40) 257 282 831, e-mail: arad@profilco-romania.ro

Iași Str. Trei Fântani Nr.1, Jud Iași, Iași  
tel: (+40) 232 251 686, fax: (+40) 232 252 072, e-mail: iasi@profilco-romania.ro

Galați Bulevardul George Coșbuc Nr 257, Jud Galați, Galați,  
tel: (+40) 236 334 145, fax: (+40) 236 334 130, e-mail: galati@profilco-romania.ro

### BULGARIA : PROFILCO BG

Sofia 68 ring road, between Dragalevtsi and Simeonovo  
tel: (+359) 2 967 33 81/2/3/4, fax: (+359) 895 70 70 01, e-mail: office@profilco-bg.com

### SERVIA : PROFILCO YU

Beograd Autoput za Novi Sad 118, 11080 Beograd-Zemun, Servia,  
tel: +381 (0)11 37 79 400, fax: +381 (0)11 37 79 450, e-mail: profilco\_yu@profilco.eu

Novi Sad Temerinski put 23-a, 21000 Novi Sad,  
tel: +381 (0)21 410 219, tel/fax: +381 (0) 21 64 13 515, e-mail: profilcons@eunet.rs

### F.Y.R.O.M. : PROFILCO MK

Skopje Street Prvomajska b.b,  
tel: (+389) 22 700891, fax: (+389) 22 700855, e-mail: profilcomk@on.net.mk

### UKRAINE : PROFILCO UA

Kiev Str. Syretskaya 25a,  
tel./fax: (+38) 044 499-60-45, 499-60-46, 499-60-34, e-mail: kiev@profilcogroup.com.ua

Odessa Odessa, 65017, Poezdnyaya 1,  
tel: (+38) 048 7031654, fax: (+38)0487486311, e-mail: odessa@profilcogroup.com.ua

Dnepropetrovsk Str. Kalinovaya 87,  
tel./fax: (+38) 056 724 72 90, 050 447 31 06, e-mail: ukraina-o@mail.ru

Lvov Str. Promyslova 52e,  
tel./fax: (+38) 032 242 33 11, 095 284 71 10, e-mail: grechko\_serg@mail.ru

Kharkov Str. Tchuguyevskaya 78,  
tel: (+38) 057 758 58 73, tel./fax: (+38) 057 758 58 93, e-mail: profilco-kharkov@ukr.net



**PROFILCO™**  
Aluminium Systems